

Plenum box for air valve

FLX-PLO/FLX-PRO



Description

FLX-PLO / FLX-PRO plenum boxes are components of the FLX-REKU system intended for domestic mechanical ventilation systems, also known as mechanical ventilation heat recovery (MVHR) or heat recovery ventilation.

The low profile plenum boxes require less installation space than standard solutions, which is very convenient when they should not be prominent once concealed. This advantage helps free up usable indoor area.

FLX-PLO plenum boxes are made of galvanized steel sheet. Plenum boxes made from stainless steel are available on request.

Available also insulated plenum box version - **FLX-PLI** and **FLX-PRI**. These plenum boxes have inside a insulation lining made from 9 mm thick rubber foam.

FLX-PLO plenum boxes are equipped with duct connection spigot $\varnothing d_2$ with a EPDM seal – this type of connection with FLX-HDPE ducting is airtight and easy to install.



FLX-CS-PVC end caps fit connection spigots of FLX-PLO-75 and FLX-PLO-90 plenum boxes.



FLX-CF-PVC end caps fit (inside) duct connection spigots of FLX-PRO-63 plenum boxes.

Product code example

Product code **FLX-PLO - 75 - 2 - 150 - F**

type _____
 diameter $\varnothing d_2$ _____
 number of spigots n _____
 diameter $\varnothing d_1$ _____
 type of connection
 male _____
 F - female _____

Dimensions

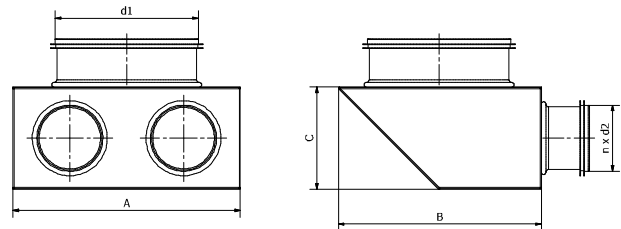

Product code	A [mm]	B [mm]	C [mm]	d_1 [mm]	n [szt.]	d_2 [mm]
FLX-PRO-63-1- d_1	180	180	75	80-160	1	63
FLX-PRO-63-2- d_1	180	180	75	80-160	2	63
FLX-PRO-63-3- d_1	180	270	75	80-160	3	63
FLX-PLO-75-1- d_1	180	200	90	80-160	1	63
FLX-PLO-75-2- d_1	180	200	90	80-160	2	63
FLX-PLO-75-3- d_1	180	300	90	80-160	3	63
FLX-PLO-90-1- d_1	180	200	90	80-160	1	75
FLX-PLO-90-2- d_1	180	200	90	80-160	2	75
FLX-PLO-90-3- d_1	180	300	90	80-160	3	75

Duct connection spigot d_1 : 80, 100, 125, 150, 160 mm

Types of plenum boxes



FLX-PLO plenum box



FLX-PRO plenum box (spigot - 63mm only)



FLX-PLO-75-2-160 male connection spigot $\varnothing d_1$ with a seal



FLX-PLO-75-2-160-F female connection spigot $\varnothing d_1$



FLX-PLI / FLX-PRI 9 mm thick rubber foam insulation lining